

# Vigas H Alas Anchas WF

ESTÁNDAR AMERICANO

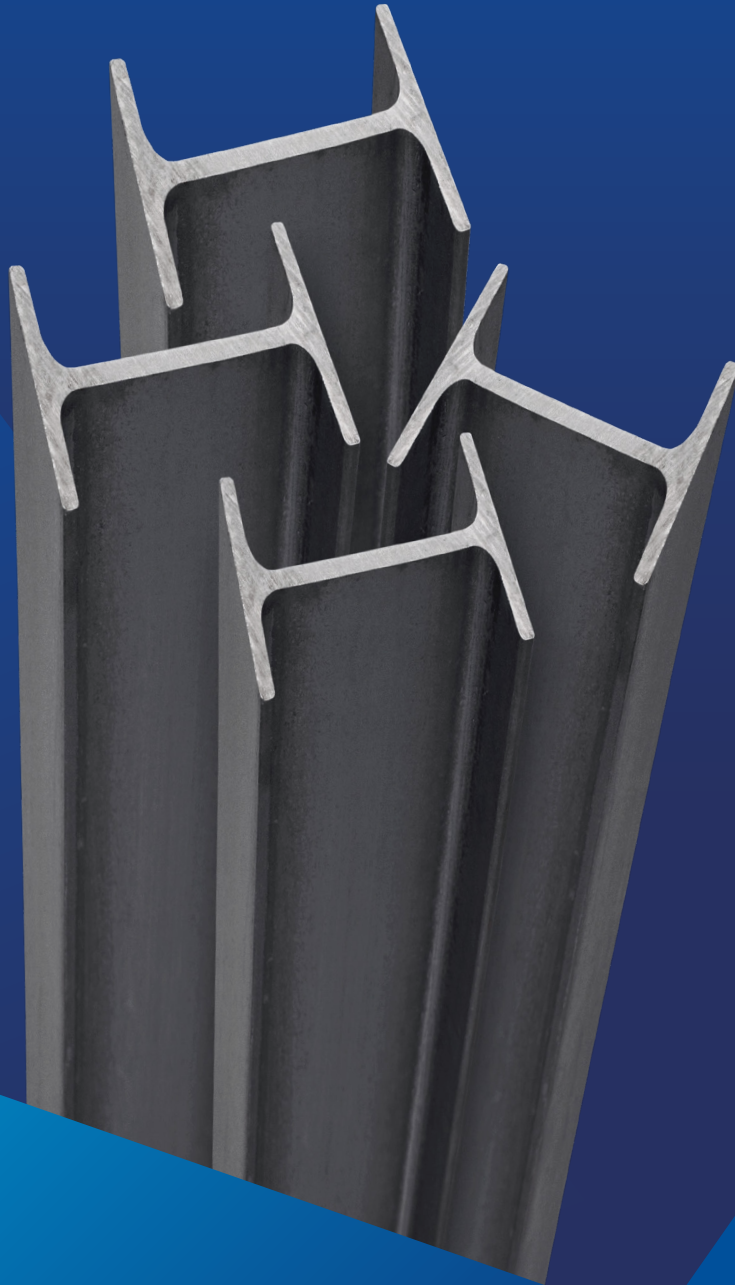

**ACEROS  
AREQUIPA**

**LA SEGURIDAD  
DE UN FIERRAZO**

# Vigas H Alas Anchas WF

## ESTÁNDAR AMERICANO

### DENOMINACIÓN:

VIGAS H ALAS ANCHAS (WF).

### DESCRIPCIÓN:

Producto laminado en caliente con sección en forma de "H" (con alas paralelas), de calidad estructural en cumplimiento con las normas ASTM A36, ASTM A572 Grado 50 o la ASTM A992. Asimismo, pueden presentarse en calidad dual.

### USOS:

En la fabricación de estructuras metálicas, edificios, puentes grúas, estructuras en general, cerchas, etc.

### NORMAS TÉCNICAS:

- Composición Química y Propiedades Mecánicas: ASTM A36/A36M, ASTM A572/A572M, ASTM A992/A992M.
- Tolerancia Dimensional: ASTM A6 /A6M.

### PRESENTACIÓN:

Se comercializan en barras de 20, 30 y 40 pies. Otras longitudes a pedido.

### DIMENSIONES ESTÁNDAR:

DESIGNACIÓN NOMINAL		PERALTE ALTURA ALMA (d) pulgada	ALA (b) pulgada	ESPESOR NOMINAL	
pulgada	lb/pie			ALA (f)	ALMA (w)
4"	13.00	4.16	4.06	8.76	7.11
6"	9.00	5.90	3.94	5.46	4.32
6"	12.00	6.03	4.00	7.11	5.84
6"	16.00	6.28	4.03	10.29	6.60
6"	15.00	5.99	5.99	6.60	5.84
6"	20.00	6.20	6.02	9.27	6.60
6"	25.00	6.38	6.08	11.56	8.13
8"	10.00	7.89	3.94	5.21	4.32
8"	13.00	7.99	4.00	6.48	5.84
8"	15.00	8.11	4.02	8.00	6.22
8"	18.00	8.14	5.25	8.38	5.84
8"	21.00	8.28	5.27	10.16	6.35
8"	24.00	7.93	6.50	10.16	6.22
8"	28.00	8.06	6.54	11.81	7.24
8"	31.00	8.00	8.00	11.05	7.24
8"	35.00	8.12	8.02	12.57	7.87
8"	40.00	8.25	8.07	14.22	9.14
8"	48.00	8.50	8.11	17.40	10.16
8"	58.00	8.75	8.22	20.57	12.95
8"	67.00	9.00	8.28	23.75	14.48
10"	12.00	9.87	3.96	5.33	4.83
10"	15.00	9.99	4.00	6.86	5.84
10"	17.00	10.11	4.01	8.38	6.10

DESIGNACIÓN NOMINAL		PERALTE ALTURA ALMA (d) pulgada	ALA (b) pulgada	ESPESOR NOMINAL	
pulgada	lb/pie			ALA (f)	ALMA (w)
10"	19.00	10.24	4.02	10.03	6.35
10"	22.00	10.17	5.75	9.14	6.10
10"	26.00	10.33	5.77	11.18	6.60
10"	30.00	10.47	5.81	12.95	7.62
10"	33.00	9.73	7.96	11.05	7.37
10"	39.00	9.92	7.99	13.46	8.00
10"	45.00	10.10	8.02	15.75	8.89
10"	49.00	9.98	10.00	14.22	8.64
10"	54.00	10.09	10.03	15.62	9.40
10"	60.00	10.22	10.08	17.27	10.67
10"	68.00	10.40	10.13	19.56	11.94
10"	77.00	10.40	10.19	22.10	13.46
10"	88.00	10.84	10.27	25.15	15.37
10"	100.00	11.10	10.34	28.45	17.27
12"	14.00	11.91	3.97	5.72	5.08
12"	16.00	11.99	3.99	6.73	5.59
12"	19.00	12.16	4.01	8.89	5.97
12"	22.00	12.31	4.03	10.80	6.60
12"	26.00	12.22	6.49	9.65	5.84
12"	30.00	12.34	6.52	11.18	6.60
12"	35.00	12.50	6.56	13.21	7.62
12"	40.00	11.94	8.01	13.08	7.49
12"	45.00	12.06	8.05	14.61	8.51
12"	50.00	12.19	8.08	16.26	9.40
12"	53.00	12.06	10.00	14.61	8.76
12"	58.00	12.19	10.01	16.26	9.14
12"	65.00	12.12	12.00	15.37	9.91
12"	72.00	12.25	12.04	17.02	10.92
12"	79.00	12.38	12.08	18.67	11.94
12"	87.00	12.53	12.13	20.57	13.08
12"	96.00	12.71	12.16	22.86	13.97
12"	106.00	12.89	12.22	25.15	15.49
12"	120.00	13.12	12.32	28.07	18.03
12"	136.00	13.41	12.40	31.75	20.07
12"	152.00	13.71	12.48	35.56	22.10
14"	22.00	13.74	5.00	8.51	5.84
14"	26.00	13.91	5.03	10.67	6.48
14"	30.00	13.84	6.73	9.78	6.86
14"	34.00	13.98	6.75	11.56	7.24
14"	38.00	14.10	6.77	13.08	7.87
14"	43.00	13.66	8.00	13.46	7.75
14"	48.00	13.79	8.03	15.11	8.64
14"	53.00	13.92	8.06	16.76	9.40
14"	61.00	13.89	10.00	16.38	9.53
14"	68.00	14.04	10.04	18.29	10.54
14"	74.00	14.17	10.07	19.94	11.43
14"	82.00	14.31	10.13	21.72	12.95
14"	90.00	14.02	14.52	21.72	11.18

QCQA01-F243/01/SEP 20

Previo acuerdo se comercializa en otras medidas.

# Vigas H Alas Anchas WF

## ESTÁNDAR AMERICANO

DESIGNACIÓN NOMINAL		PERALTE ALTURA ALMA (d) pulgada	ALA (b) pulgada	ESPESOR NOMINAL	
pulgada	lb/pie			ALA (f)	ALMA (w)
14"	99.00	14.16	14.57	19.81	12.32
14"	109.00	14.32	14.61	21.84	13.34
14"	120.00	14.48	14.67	23.88	14.99
14"	132.00	14.66	14.73	26.16	16.38
14"	145.00	14.78	15.50	27.69	17.27
14"	159.00	14.98	15.57	30.23	18.92
14"	176.00	15.22	15.65	33.27	21.08
14"	193.00	15.48	15.71	36.58	22.61
16"	26.00	15.69	5.50	8.76	6.35
16"	31.00	15.88	5.53	11.18	6.99
16"	36.00	15.86	6.99	10.92	7.49
16"	40.00	16.01	7.00	12.83	7.75
16"	45.00	16.13	7.04	14.35	8.76
16"	50.00	16.26	7.07	16.00	9.65
16"	57.00	16.43	7.12	18.16	10.92
16"	67.00	16.33	10.24	16.89	10.03
16"	77.00	16.52	10.30	19.30	11.56
16"	89.00	16.75	10.37	22.23	13.34
16"	100.00	16.97	10.43	25.02	14.86
18"	35.00	17.70	6.00	10.80	7.62
18"	40.00	17.90	6.02	13.34	8.00
18"	46.00	18.06	6.06	15.37	9.14
18"	50.00	17.99	7.50	14.48	9.02
18"	55.00	18.11	7.53	16.00	9.91
18"	60.00	18.24	7.56	17.65	10.54
18"	65.00	18.35	7.59	19.05	11.43
18"	71.00	18.47	7.64	20.57	12.57
18"	76.00	18.21	11.04	17.27	10.80
18"	86.00	18.39	11.09	19.56	12.19
18"	97.00	18.59	11.15	22.10	13.59
18"	106.00	18.73	11.20	23.88	14.99
18"	130.00	19.25	11.16	30.48	17.02
18"	158.00	19.72	11.30	36.58	20.57
21"	44.00	20.66	6.50	11.43	8.89
21"	50.00	20.83	6.53	13.59	9.65
21"	55.00	20.80	8.22	13.26	9.53
21"	57.00	21.06	6.56	16.51	10.29
21"	62.00	20.99	8.24	15.62	10.16
21"	68.00	21.13	8.27	17.40	10.92
21"	73.00	21.24	8.30	18.80	11.56
21"	83.00	21.43	8.36	21.21	13.08
21"	93.00	21.62	8.42	23.62	14.73
21"	101.00	21.36	12.29	20.32	12.70
21"	111.00	21.51	12.34	22.23	13.97
21"	122.00	21.68	12.39	24.38	15.24
21"	132.00	21.83	12.44	26.29	16.51
21"	147.00	22.06	12.51	29.21	18.29
21"	166.00	22.48	12.42	34.54	19.05

DESIGNACIÓN NOMINAL		PERALTE ALTURA ALMA (d) pulgada	ALA (b) pulgada	ESPESOR NOMINAL	
pulgada	lb/pie			ALA (f)	ALMA (w)
21"	201.00	23.03	12.58	41.40	23.11
24"	55.00	23.57	7.01	12.83	10.03
24"	62.00	23.74	7.04	14.99	10.92
24"	68.00	23.73	8.97	14.86	10.54
24"	76.00	23.92	8.99	17.27	11.18
24"	84.00	24.10	9.02	19.56	11.94
24"	94.00	24.31	9.07	22.23	13.08
24"	104.00	24.06	12.75	19.05	12.70
24"	117.00	24.26	12.80	21.59	13.97
24"	131.00	24.48	12.86	24.38	15.37
24"	146.00	24.74	12.90	27.69	16.51
24"	162.00	25.00	12.96	30.99	17.91
24"	176.00	25.24	12.89	34.04	19.05
24"	192.00	25.47	12.95	37.08	20.57
24"	250.00	26.34	13.19	48.01	26.42
27"	84.00	26.71	9.96	16.26	11.68
27"	94.00	26.92	9.99	18.92	12.45
27"	102.00	27.09	10.02	21.08	13.08
27"	114.00	27.29	10.07	23.62	14.48
27"	129.00	27.63	10.01	27.94	15.49
27"	161.00	27.59	14.02	27.43	16.76
27"	235.00	28.66	14.19	40.89	23.11
27"	307.00	29.61	14.45	53.09	29.46
30"	90.00	29.53	10.40	15.49	11.94
30"	99.00	29.65	10.45	17.02	13.21
30"	108.00	29.83	10.48	19.30	13.84
30"	116.00	30.01	10.50	21.59	14.35
30"	124.00	30.17	10.52	23.62	14.86
30"	132.00	30.31	10.55	25.40	15.62
30"	148.00	30.67	10.48	29.97	16.51
33"	118.00	32.86	11.48	18.80	13.97
33"	152.00	33.49	11.57	26.80	16.13
33"	169.00	33.82	11.50	30.99	17.02
36"	150.00	35.85	11.98	23.88	15.88
36"	160.00	36.01	12.00	25.91	16.51
36"	194.00	36.49	12.12	32.00	19.43
36"	232.00	37.12	12.12	39.88	22.10

QCQA01-F243/01/SEP 20

Previo acuerdo se comercializa en otras medidas.

# Vigas H Alas Anchas WF

## ESTÁNDAR AMERICANO

### PROPIEDADES MECÁNICAS:

NORMA TÉCNICA	GRADO	LÍMITE DE FLUENCIA MPa ≥	CARGA DE ROTURA MPa ≥	ELONGACIÓN % ≥
ASTM A 36/A 36M		250	400 - 550	21 (2") 20 (8")
ASTM A 572/A 572M	50	345	450 mín	21 (2") 16 (8")
ASTM A 992/A 992M		345	450 - 550	21 (2") 18 (8")

( ) Tamaño de probeta.

### TOLERANCIAS:

De acuerdo al ASTM A 6/A 6M.

### LONGITUD ESTÁNDAR:

30 pies y 40 pies.

QCQA01-F243/01/SEP 20



ISO 9001:2015

CERTIFICATE N° 57219



ISO 14001:2015

CERTIFICATE N° 57220



ISO 45001:2018

CERTIFICATE N° 57221

### PERÚ

LIMA: Av. Antonio Miró Quesada N.° 425, piso 17, Magdalena del Mar. Tel. (51-01) 517 1800.

PISCO: Panamericana Sur, Km. 240, Ica. Tel. (51-056) 58 0830.

AREQUIPA: Variante de Uchumayo Km 5.5, Cerro Colorado, Arequipa. Tel. (51-01) 517 1800.

### BOLIVIA

LA PAZ: Calle E - Lote 14, manzano A-08, Urbanización Cervecería Boliviana Nacional - Bellavista Viacha. Tel. (591) 75555819/77641658.

SANTA CRUZ: Urb. Parque Industrial Latinoamericano, Unidad Industrial UI 06, Mz. 1, lote 4 - Warnes. Tel. (591) 75555819/77641656.

COCHABAMBA: Calle Tte. Monasterios S/N Zona la Maica - Cochabamba. Tel. (591) 75555819/69417963. E-mail: contactobolivia@caa.com.bo

### CHILE

ANTOFAGASTA: Ruta A-26 KM 2.4, El Salar. Tel.: (56) 939249279. E-mail: contacto@acerosamerica.com

Encuétranos en:

[www.acerosarequipa.com](http://www.acerosarequipa.com)



**ACEROS  
AREQUIPA**