

Vigas H Alas Anchas WF

ESTÁNDAR AMERICANO

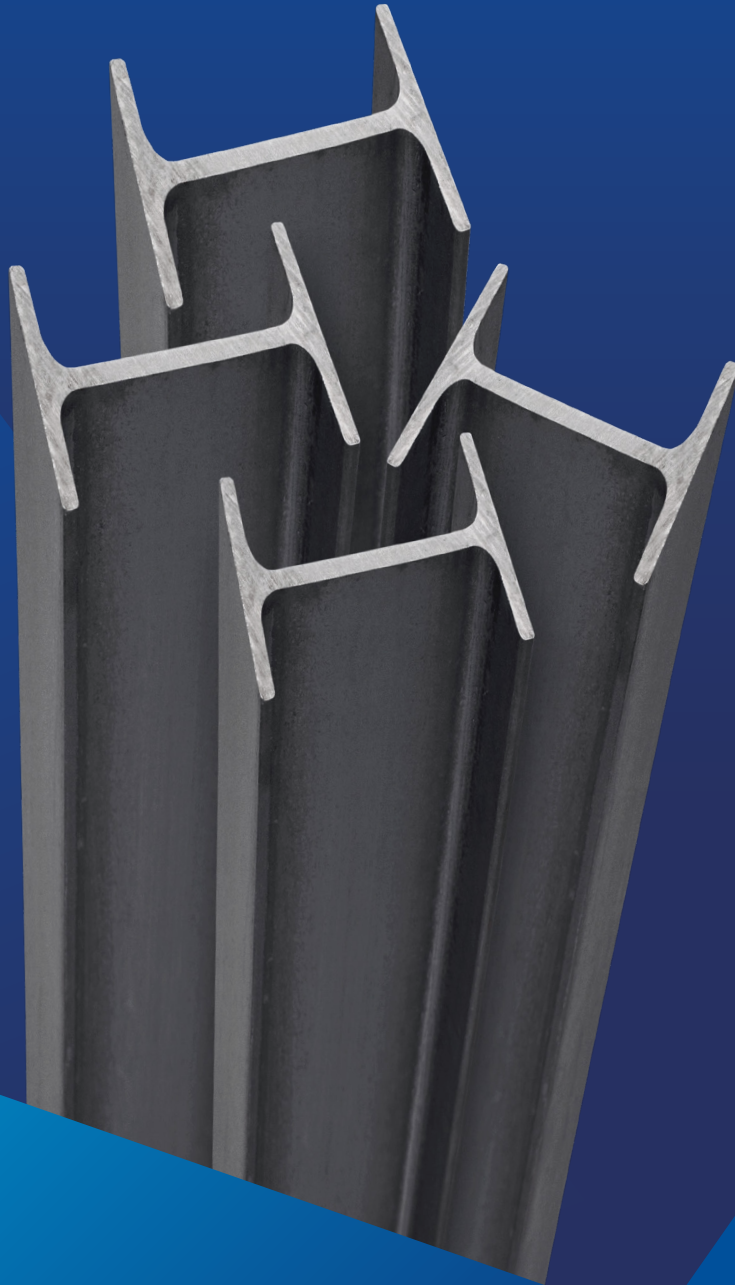

**ACEROS
AREQUIPA**

**LA SEGURIDAD
DE UN FIERRAZO**

*Imágenes referenciales.

Vigas H Alas Anchas WF

ESTÁNDAR AMERICANO

DENOMINACIÓN:

VIGAS H ALAS ANCHAS (WF).

DESCRIPCIÓN:

Producto laminado en caliente con sección en forma de "H" (con alas paralelas), de calidad estructural en cumplimiento con las normas ASTM A36, ASTM A572 Grado 50 o la ASTM A992. Asimismo, pueden presentarse en calidad dual.

USOS:

En la fabricación de estructuras metálicas, edificios, puentes grúas, estructuras en general, cerchas, etc.

NORMAS TÉCNICAS:

- Composición Química y Propiedades Mecánicas: ASTM A36/A36M, ASTM A572/A572M, ASTM A992/A992M.
- Tolerancia Dimensional: ASTM A6 /A6M.

PRESENTACIÓN:

Se comercializan en barras de 20, 30 y 40 pies. Otras longitudes a pedido.

DIMENSIONES ESTÁNDAR:

DESIGNACIÓN NOMINAL		PERALTE ALTURA ALMA (d) pulgada	ALA (b) pulgada	ESPESOR NOMINAL	
pulgada	lb/pie			ALA (f)	ALMA (w)
4"	13.00	4.16	4.06	8.76	7.11
6"	9.00	5.90	3.94	5.46	4.32
6"	12.00	6.03	4.00	7.11	5.84
6"	16.00	6.28	4.03	10.29	6.60
6"	15.00	5.99	5.99	6.60	5.84
6"	20.00	6.20	6.02	9.27	6.60
6"	25.00	6.38	6.08	11.56	8.13
8"	10.00	7.89	3.94	5.21	4.32
8"	13.00	7.99	4.00	6.48	5.84
8"	15.00	8.11	4.02	8.00	6.22
8"	18.00	8.14	5.25	8.38	5.84
8"	21.00	8.28	5.27	10.16	6.35
8"	24.00	7.93	6.50	10.16	6.22
8"	28.00	8.06	6.54	11.81	7.24
8"	31.00	8.00	8.00	11.05	7.24
8"	35.00	8.12	8.02	12.57	7.87
8"	40.00	8.25	8.07	14.22	9.14
8"	48.00	8.50	8.11	17.40	10.16
8"	58.00	8.75	8.22	20.57	12.95
8"	67.00	9.00	8.28	23.75	14.48
10"	12.00	9.87	3.96	5.33	4.83
10"	15.00	9.99	4.00	6.86	5.84
10"	17.00	10.11	4.01	8.38	6.10

DESIGNACIÓN NOMINAL		PERALTE ALTURA ALMA (d) pulgada	ALA (b) pulgada	ESPESOR NOMINAL	
pulgada	lb/pie			ALA (f)	ALMA (w)
10"	19.00	10.24	4.02	10.03	6.35
10"	22.00	10.17	5.75	9.14	6.10
10"	26.00	10.33	5.77	11.18	6.60
10"	30.00	10.47	5.81	12.95	7.62
10"	33.00	9.73	7.96	11.05	7.37
10"	39.00	9.92	7.99	13.46	8.00
10"	45.00	10.10	8.02	15.75	8.89
10"	49.00	9.98	10.00	14.22	8.64
10"	54.00	10.09	10.03	15.62	9.40
10"	60.00	10.22	10.08	17.27	10.67
10"	68.00	10.40	10.13	19.56	11.94
10"	77.00	10.40	10.19	22.10	13.46
10"	88.00	10.84	10.27	25.15	15.37
10"	100.00	11.10	10.34	28.45	17.27
12"	14.00	11.91	3.97	5.72	5.08
12"	16.00	11.99	3.99	6.73	5.59
12"	19.00	12.16	4.01	8.89	5.97
12"	22.00	12.31	4.03	10.80	6.60
12"	26.00	12.22	6.49	9.65	5.84
12"	30.00	12.34	6.52	11.18	6.60
12"	35.00	12.50	6.56	13.21	7.62
12"	40.00	11.94	8.01	13.08	7.49
12"	45.00	12.06	8.05	14.61	8.51
12"	50.00	12.19	8.08	16.26	9.40
12"	53.00	12.06	10.00	14.61	8.76
12"	58.00	12.19	10.01	16.26	9.14
12"	65.00	12.12	12.00	15.37	9.91
12"	72.00	12.25	12.04	17.02	10.92
12"	79.00	12.38	12.08	18.67	11.94
12"	87.00	12.53	12.13	20.57	13.08
12"	96.00	12.71	12.16	22.86	13.97
12"	106.00	12.89	12.22	25.15	15.49
12"	120.00	13.12	12.32	28.07	18.03
12"	136.00	13.41	12.40	31.75	20.07
12"	152.00	13.71	12.48	35.56	22.10
14"	22.00	13.74	5.00	8.51	5.84
14"	26.00	13.91	5.03	10.67	6.48
14"	30.00	13.84	6.73	9.78	6.86
14"	34.00	13.98	6.75	11.56	7.24
14"	38.00	14.10	6.77	13.08	7.87
14"	43.00	13.66	8.00	13.46	7.75
14"	48.00	13.79	8.03	15.11	8.64
14"	53.00	13.92	8.06	16.76	9.40
14"	61.00	13.89	10.00	16.38	9.53
14"	68.00	14.04	10.04	18.29	10.54
14"	74.00	14.17	10.07	19.94	11.43
14"	82.00	14.31	10.13	21.72	12.95
14"	90.00	14.02	14.52	21.72	11.18

QCQA01-F243/01/SEP 20

Previo acuerdo se comercializa en otras medidas.

Vigas H Alas Anchas WF

ESTÁNDAR AMERICANO

DESIGNACIÓN NOMINAL		PERALTE ALTURA ALMA (d) pulgada	ALA (b) pulgada	ESPESOR NOMINAL	
pulgada	lb/pie			ALA (f)	ALMA (w)
14"	99.00	14.16	14.57	19.81	12.32
14"	109.00	14.32	14.61	21.84	13.34
14"	120.00	14.48	14.67	23.88	14.99
14"	132.00	14.66	14.73	26.16	16.38
14"	145.00	14.78	15.50	27.69	17.27
14"	159.00	14.98	15.57	30.23	18.92
14"	176.00	15.22	15.65	33.27	21.08
14"	193.00	15.48	15.71	36.58	22.61
16"	26.00	15.69	5.50	8.76	6.35
16"	31.00	15.88	5.53	11.18	6.99
16"	36.00	15.86	6.99	10.92	7.49
16"	40.00	16.01	7.00	12.83	7.75
16"	45.00	16.13	7.04	14.35	8.76
16"	50.00	16.26	7.07	16.00	9.65
16"	57.00	16.43	7.12	18.16	10.92
16"	67.00	16.33	10.24	16.89	10.03
16"	77.00	16.52	10.30	19.30	11.56
16"	89.00	16.75	10.37	22.23	13.34
16"	100.00	16.97	10.43	25.02	14.86
18"	35.00	17.70	6.00	10.80	7.62
18"	40.00	17.90	6.02	13.34	8.00
18"	46.00	18.06	6.06	15.37	9.14
18"	50.00	17.99	7.50	14.48	9.02
18"	55.00	18.11	7.53	16.00	9.91
18"	60.00	18.24	7.56	17.65	10.54
18"	65.00	18.35	7.59	19.05	11.43
18"	71.00	18.47	7.64	20.57	12.57
18"	76.00	18.21	11.04	17.27	10.80
18"	86.00	18.39	11.09	19.56	12.19
18"	97.00	18.59	11.15	22.10	13.59
18"	106.00	18.73	11.20	23.88	14.99
18"	130.00	19.25	11.16	30.48	17.02
18"	158.00	19.72	11.30	36.58	20.57
21"	44.00	20.66	6.50	11.43	8.89
21"	50.00	20.83	6.53	13.59	9.65
21"	55.00	20.80	8.22	13.26	9.53
21"	57.00	21.06	6.56	16.51	10.29
21"	62.00	20.99	8.24	15.62	10.16
21"	68.00	21.13	8.27	17.40	10.92
21"	73.00	21.24	8.30	18.80	11.56
21"	83.00	21.43	8.36	21.21	13.08
21"	93.00	21.62	8.42	23.62	14.73
21"	101.00	21.36	12.29	20.32	12.70
21"	111.00	21.51	12.34	22.23	13.97
21"	122.00	21.68	12.39	24.38	15.24
21"	132.00	21.83	12.44	26.29	16.51
21"	147.00	22.06	12.51	29.21	18.29
21"	166.00	22.48	12.42	34.54	19.05

DESIGNACIÓN NOMINAL		PERALTE ALTURA ALMA (d) pulgada	ALA (b) pulgada	ESPESOR NOMINAL	
pulgada	lb/pie			ALA (f)	ALMA (w)
21"	201.00	23.03	12.58	41.40	23.11
24"	55.00	23.57	7.01	12.83	10.03
24"	62.00	23.74	7.04	14.99	10.92
24"	68.00	23.73	8.97	14.86	10.54
24"	76.00	23.92	8.99	17.27	11.18
24"	84.00	24.10	9.02	19.56	11.94
24"	94.00	24.31	9.07	22.23	13.08
24"	104.00	24.06	12.75	19.05	12.70
24"	117.00	24.26	12.80	21.59	13.97
24"	131.00	24.48	12.86	24.38	15.37
24"	146.00	24.74	12.90	27.69	16.51
24"	162.00	25.00	12.96	30.99	17.91
24"	176.00	25.24	12.89	34.04	19.05
24"	192.00	25.47	12.95	37.08	20.57
24"	250.00	26.34	13.19	48.01	26.42
27"	84.00	26.71	9.96	16.26	11.68
27"	94.00	26.92	9.99	18.92	12.45
27"	102.00	27.09	10.02	21.08	13.08
27"	114.00	27.29	10.07	23.62	14.48
27"	129.00	27.63	10.01	27.94	15.49
27"	161.00	27.59	14.02	27.43	16.76
27"	235.00	28.66	14.19	40.89	23.11
27"	307.00	29.61	14.45	53.09	29.46
30"	90.00	29.53	10.40	15.49	11.94
30"	99.00	29.65	10.45	17.02	13.21
30"	108.00	29.83	10.48	19.30	13.84
30"	116.00	30.01	10.50	21.59	14.35
30"	124.00	30.17	10.52	23.62	14.86
30"	132.00	30.31	10.55	25.40	15.62
30"	148.00	30.67	10.48	29.97	16.51
33"	118.00	32.86	11.48	18.80	13.97
33"	152.00	33.49	11.57	26.80	16.13
33"	169.00	33.82	11.50	30.99	17.02
36"	150.00	35.85	11.98	23.88	15.88
36"	160.00	36.01	12.00	25.91	16.51
36"	194.00	36.49	12.12	32.00	19.43
36"	232.00	37.12	12.12	39.88	22.10

QCQA01-F243/01/SEP 20

Previo acuerdo se comercializa en otras medidas.

Vigas H Alas Anchas WF

ESTÁNDAR AMERICANO

PROPIEDADES MECÁNICAS:

NORMA TÉCNICA	GRADO	LÍMITE DE FLUENCIA MPa ≥	CARGA DE ROTURA MPa ≥	ELONGACIÓN % ≥
ASTM A 36/A 36M		250	400 - 550	21 (2") 20 (8")
ASTM A 572/A 572M	50	345	450 mín	21 (2") 16 (8")
ASTM A 992/A 992M		345	450 - 550	21 (2") 18 (8")

() Tamaño de probeta.

TOLERANCIAS:

De acuerdo al ASTM A 6/A 6M.

LONGITUD ESTÁNDAR:

30 pies y 40 pies.

QCQA01-F243/01/SEP 20



ISO 9001
ISO 14001
ISO 45001

CERTIFICATE N° 57219
CERTIFICATE N° 57220
CERTIFICATE N° 57221

PERÚ

LIMA: Av. Antonio Miró Quesada N.° 425, piso 17, Magdalena del Mar. Tel. (51-01) 517 1800.

PISCO: Panamericana Sur, Km. 241, Ica. Tel. (51-056) 58 0830.

AREQUIPA: Variante de Uchumayo Km 5.5, Cerro Colorado, Arequipa. Tel. (51-01) 517 1800.

BOLIVIA

LA PAZ: Calle E - Lote 14, manzano A-08, Urbanización Cervecería Boliviana Nacional - Bellavista Viacha. Tel. (591) 75555819/77641658.

SANTA CRUZ: Urb. Parque Industrial Latinoamericano, Unidad Industrial UI 06, Mz. 1, lote 4 - Warnes. Tel. (591) 75555819/77641656.

COCHABAMBA: Calle Tte. Monasterios S/N Zona la Maica - Cochabamba. Tel. (591) 75555819/69417963. E-mail: contactobolivia@caa.com.bo

COLOMBIA

CALI: Cra. 25, N.° 13-117, Yumbo, Parcelación Industrial la Y, Valle del Cauca-Colombia. Tel. (57) 324 4214893.

E-mail: contactocolombia@acerosamerica.com

CHILE

ANTOFAGASTA: Ruta A-26 KM 2.4, El Salar. Tel.: (56) 939249279. E-mail: contacto@acerosamerica.com